

TRUE NORTH

- LEGEND:-**
- VC denotes VEHICLE CROSSING
  - PC denotes PEDESTRIAN CROSSING
  - BK denotes BACK OF KERB
  - TK denotes TOP OF KERB
  - GUT denotes KERB GUTTER
  - LIP denotes LIP LINE
  - COM denotes COMMUNICATIONS PIT
  - GAS denotes GAS MARKER/LID
  - PP denotes POWER POLE
  - LP denotes LIGHT POLE
  - EP denotes ELECTRICITY PIT
  - ELP denotes ELECTRICITY PILLAR
  - EB denotes ELECTRICITY BOX
  - HYD denotes HYDRANT
  - RHYD denotes RECYCLED HYDRANT
  - SV denotes STOP VALVE
  - RSV denotes RECYCLED STOP VALVE
  - WM denotes POTABLE WATER METER
  - RWM denotes RECYCLED WATER METER
  - SWP denotes STORMWATER PIT
  - SL denotes SURFACE LEVEL
  - IL denotes INVERT LEVEL
  - SMH denotes SEWER MANHOLE
  - SIP denotes SEWER INSPECTION PIT
  - TS denotes TRAFFIC SIGNAL
  - TSP denotes TRAFFIC SIGNAL PIT
  - SS denotes STREET SIGN
  - US denotes UNCLASSIFIED SERVICE
  - MH denotes UNCLASSIFIED MANHOLE
  - FCE denotes FENCE
  - FL denotes FLOOR LEVEL
  - TOW denotes TOP OF WALL
  - BOW denotes BOTTOM OF WALL
  - D:S:H denotes DIAMETER, SPREAD and HEIGHT OF TREE

- GENERAL NOTES:-**
1. THIS SURVEY IS NOT A 'LAND SURVEY' AS DEFINED BY THE SURVEYING AND SPATIAL INFORMATION ACT, 2002.
  2. THE BOUNDARIES OF THE LAND HAVE NOT BEEN SURVEYED. THE RELATIONSHIP BETWEEN THE BOUNDARIES SHOWN AND FEATURES SURVEYED ARE APPROXIMATE AND SUITABLE FOR PLOTTING PURPOSES ONLY.
  3. ONLY THOSE SERVICES VISIBLE AT THE TIME OF SURVEY HAVE BEEN LOCATED AND ARE QUALITY LEVEL A AS DEFINED BY AS 5488-2013.
  4. UNDERGROUND SERVICES HAVE BEEN PLOTTED FROM 'DIAL-BEFORE-YOU-DIG' PLANS AND ARE QUALITY LEVEL D AS DEFINED BY AS 5488-2013. ALL RELEVANT AUTHORITIES MUST BE CONTACTED TO DETERMINE THE FULL EXTENT OF SERVICES PRIOR TO ANY PLANNING OR WORKS NEAR THE SITE.
  5. ONLY TREES GREATER THAN 3.5 METRES IN HEIGHT ARE SHOWN ON THIS PLAN AND THEIR POSITIONS AREA DIAGRAMMATIC ONLY AND MAY REQUIRE ADDITIONAL SURVEY WHERE CRITICAL TO DESIGN.
  6. CONTOURS ARE INDICATIVE AT GROUND FORM ONLY. SPOT LEVELS ONLY SHOULD BE USED FOR CALCULATIONS OF QUANTITIES WITH CAUTION.
  7. CONTOUR INTERVAL 0.5 m.
  8. ALL SETOUT LEVELS MUST BE REFERRED TO THE BENCH MARK.
  9. THE ORIGIN OF AHD COMES FROM SCIMS MARK PM 48958 RL 62.58
  10. THE ORIENTATION OF THIS PLAN IS TRUE NORTH.
  11. COVENANTS AND RESTRICTIONS NOTED ON THE TITLE HAVE NOT BEEN INVESTIGATED.

**UNDERGROUND SERVICES LEGEND - QUALITY LEVEL D (AS 5488-2013)**

- POTABLE WATER MAIN
- RECYCLED WATER MAIN
- STORMWATER PIPE
- SEWER MAIN
- COMMUNICATIONS CABLES
- ELECTRICITY CABLES
- GAS MAIN
- UNIDENTIFIED SERVICES

APPROXIMATE POSITION ONLY VIDE 'DIAL-BEFORE-YOU-DIG' PLANS JOB No. 1234567. WHERE CRITICAL TO DESIGN, UNDERGROUND SERVICES SHOULD BE LOCATED BY MORE ACCURATE METHODS.

CAUTION: FIBRE OPTIC CABLES ARE PRESENT IN THIS AREA

- SERVICES NOTES:-**
1. ONLY THOSE SERVICES VISIBLE AT THE TIME OF SURVEY HAVE BEEN LOCATED AND IF SHOWN AS '+ 89.67' ARE QUALITY LEVEL A AS DEFINED BY AS 5488-2013. LEVELS SHOWN ARE SURFACE LEVELS UNLESS NOTED OTHERWISE.
  2. UNDERGROUND SERVICES HAVE BEEN PLOTTED FROM 'DIAL-BEFORE-YOU-DIG' PLANS AND ARE QUALITY LEVEL D AS DEFINED BY AS 5488-2013. ALL RELEVANT AUTHORITIES MUST BE CONTACTED TO DETERMINE THE FULL EXTENT OF SERVICES PRIOR TO ANY PLANNING OR WORKS NEAR THE SITE.

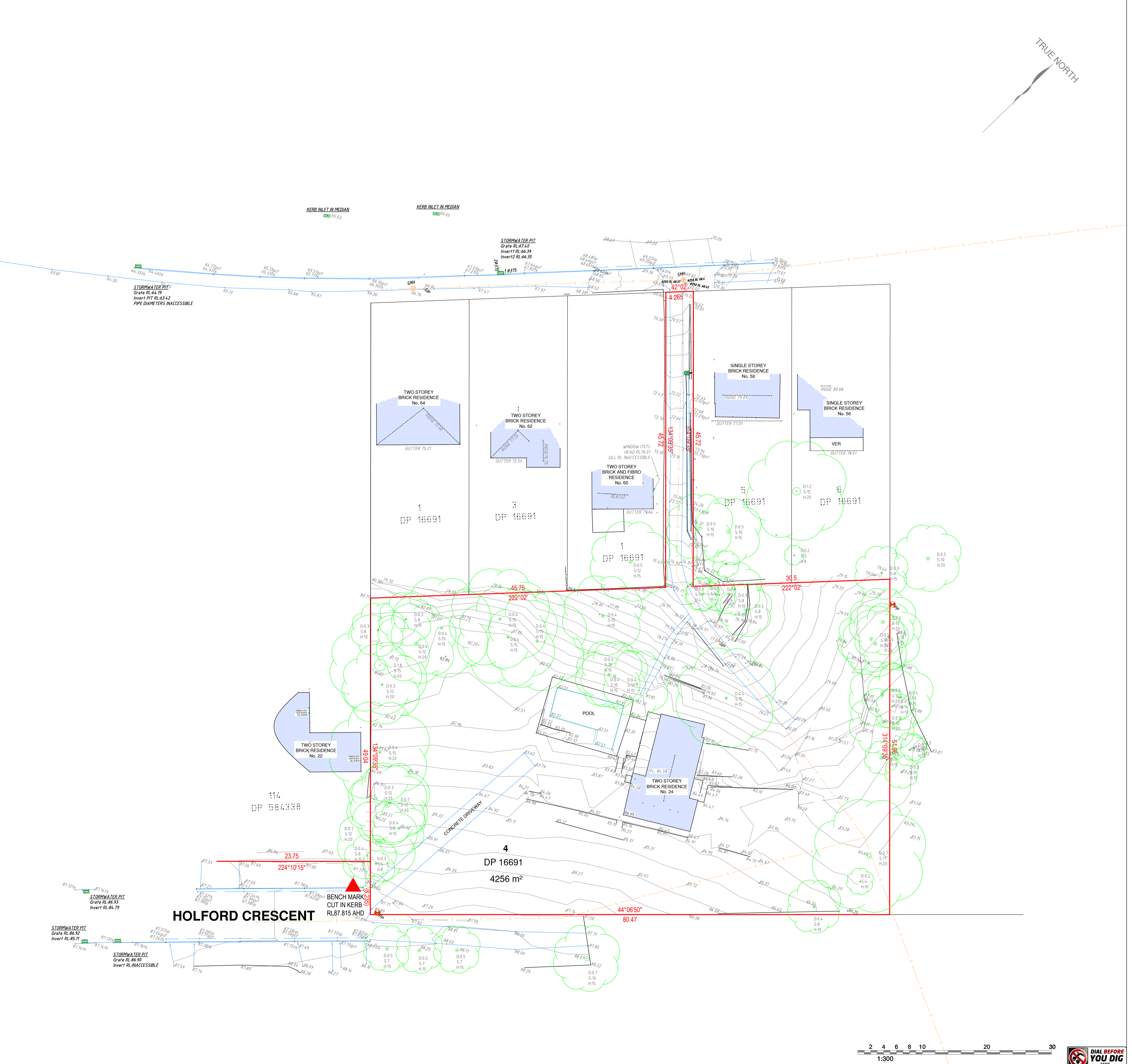

<p>©COPYRIGHT SDG is the owner of the copyright subsisting in these drawings, plans, designs and specifications. They must not be used, reproduced or copied in whole or in part without prior written consent of SDG</p>	ISSUE	DATE	AMENDMENT	CLIENT: <b>BIN XU</b>	SCALE 1:300 ORIGIN OF LEVELS: PM48958 RL 62.58	REF.: 7011 DATE: 16/03/16 SURV/CHK: NC/GE SHEET 1 OF 1 SHEETS	PLAN A1 ISSUE A	DETAIL AND LEVEL SURVEY OF LOT 4 IN DP16691 GORDON 24 HOLFORD CRESCENT
	A	16/03/16	ORIGINAL ISSUE					
	B	24/03/16	ADJOINING BOUNDARY ADDED					
	C	11/04/16	DETAIL AMENDED					
	D	3/06/16	ADDITIONAL DETAIL ADDED					

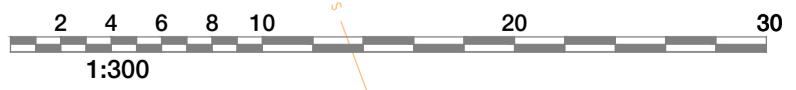

**DIAL BEFORE YOU DIG**  
www.DBD.com.au

Suite 1, 3 Railway Street  
BAULKHAM HILLS 2153  
P.O. Box 2052  
NORTH Parramatta 1750  
T: 02 9600 7950  
e: office@sdg.net.au  
w: www.sdg.net.au

**SDG**  
LAND DEVELOPMENT SOLUTIONS  
A.B.N. 85 513 523 691